

COLUMN MOUNTING

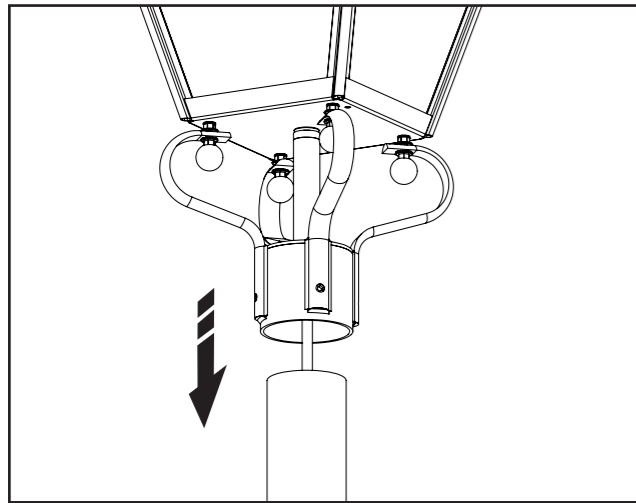

! Take care to not trap any cables

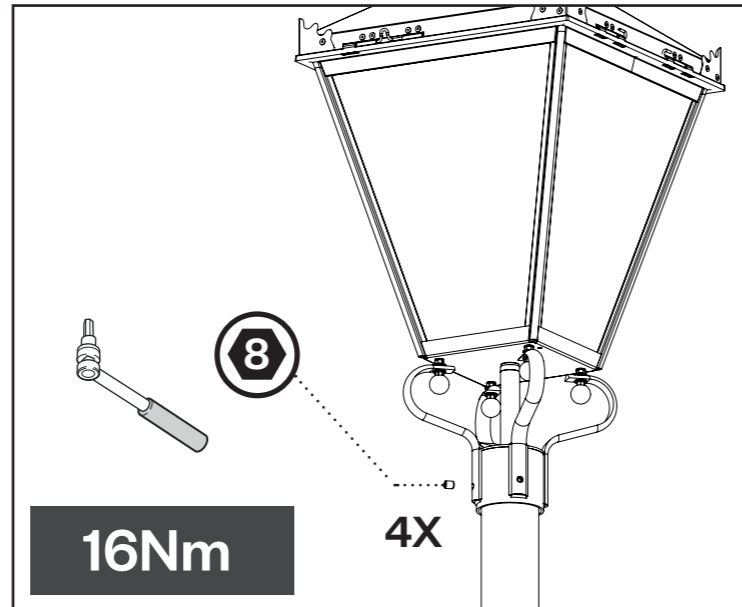

16Nm

4X

MAINTENANCE ACCESS

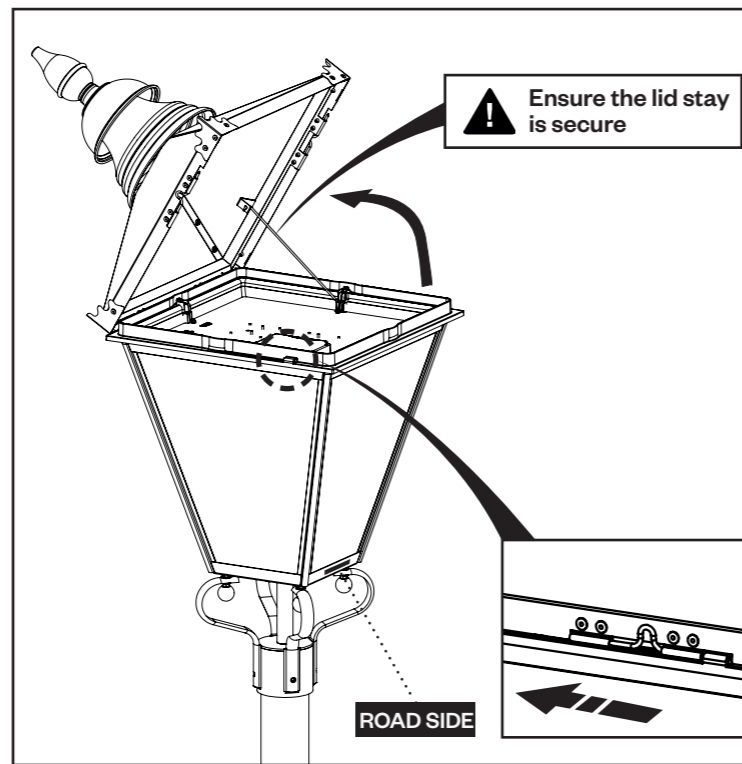

! Ensure the lid stay is secure

ROAD SIDE

Unfasten the two side catches holding the lid in position, hinge up the lid and support it with the lid stay

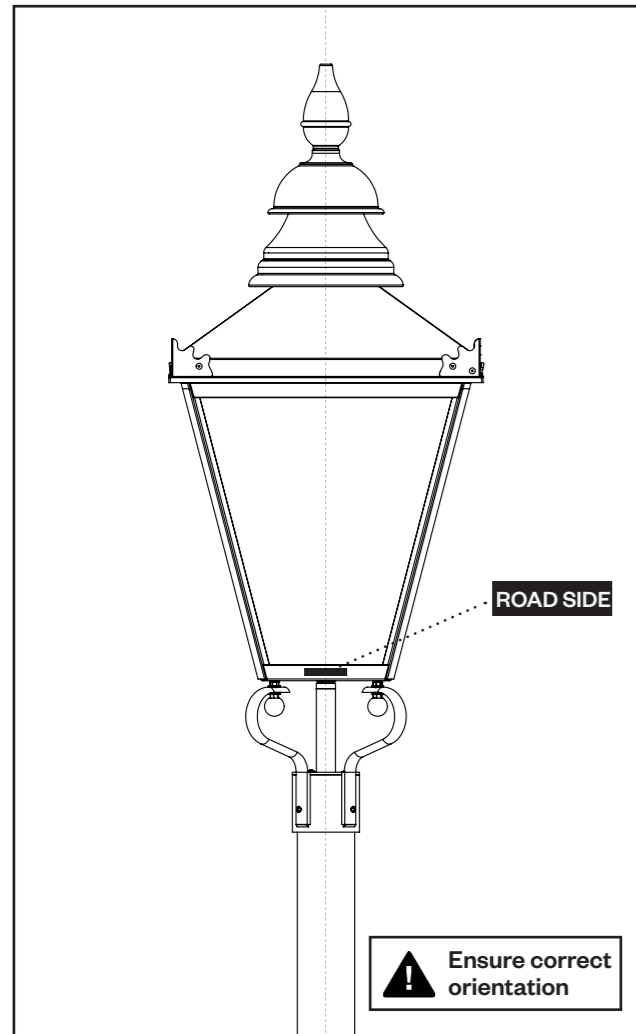

! Ensure correct orientation

ROAD SIDE

! ENSURE LANTERN IS VERTICAL

Installation Instructions

10/630/11 Rev C



IP65 IK08

230VAC 50Hz

! **!** IMPORTANT

- DISCONNECT ELECTRICAL SUPPLY BEFORE INSTALLATION OR SERVICING.
- THIS PRODUCT MUST BE EARTHED.
- THIS PRODUCT IS DESIGNED TO OPERATE OUTDOORS.
- THIS PRODUCT CONTAINS A LIGHT SOURCE OF ENERGY EFFICIENCY CLASS C TO F, THIS IS DEPENDENT ON PRODUCT DRIVE CURRENT, LED COLOUR TEMPERATURE & OPTIC.
- DO NOT STARE AT OPERATING LIGHT SOURCE.
- PERSONNEL TO WEAR PROTECTIVE SAFETY GLASS COMPLIANT WITH EN166 1F/EN169-5 WHEN COMMISSIONING OR MAINTAINING THIS LUMINAIRE.
- BASIC INSULATION IS PROVIDED BETWEEN POWER & DALI.
- ALWAYS MAINTAIN BASIC INSULATION BETWEEN LOW VOLTAGE SUPPLY AND CONTROL.
- LEDS CONTAINED WITHIN THIS LUMINAIRE SHALL ONLY BE REPLACED BY THE MANUFACTURER, THEIR SERVICE AGENT OR SIMILAR QUALIFIED PERSON.
- THE LUMINAIRE SHOULD BE POSITIONED SO THAT PROLONGED STARING INTO THE LUMINAIRE AT A DISTANCE CLOSER THAN 2.7 METERS IS NOT EXPECTED.

PRODUCT DETAILS

	FROG BASE	CAST BASE
CxS	0.230 m ²	0.213 m ²
Weight	7.9 kg	7.8kg

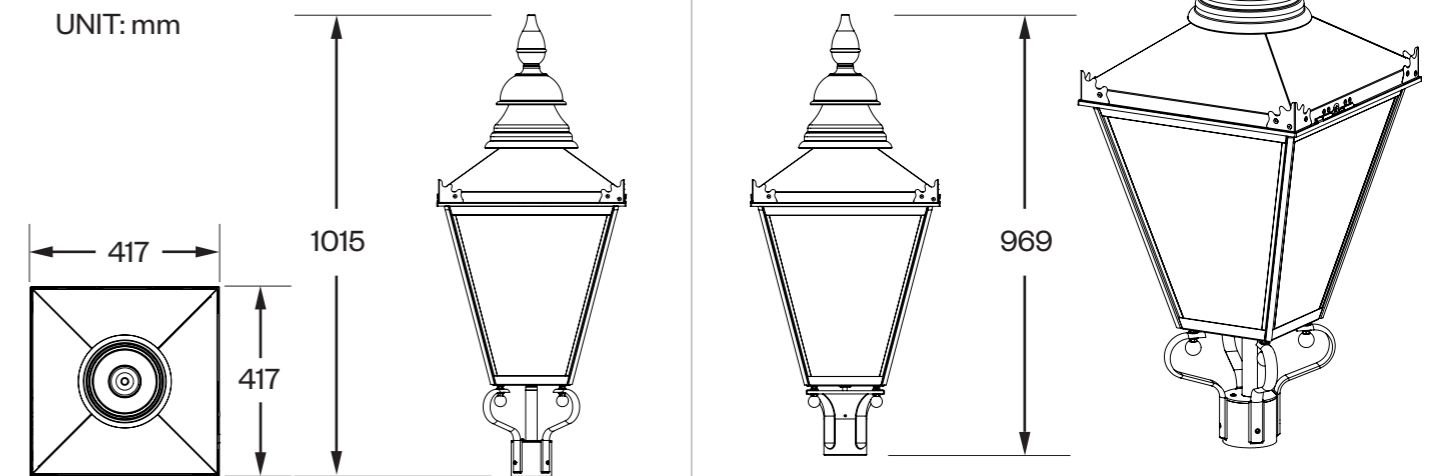

TOOLS REQUIRED



TORQUE DRIVER

POZI / SLOTTED SCREWDRIVER

BASE ATTACHMENT

FROG BASE

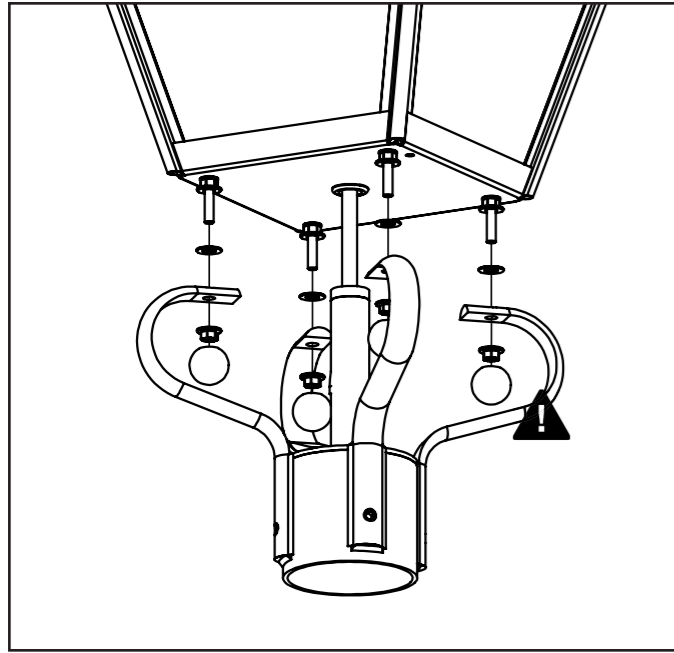

CAST BASE

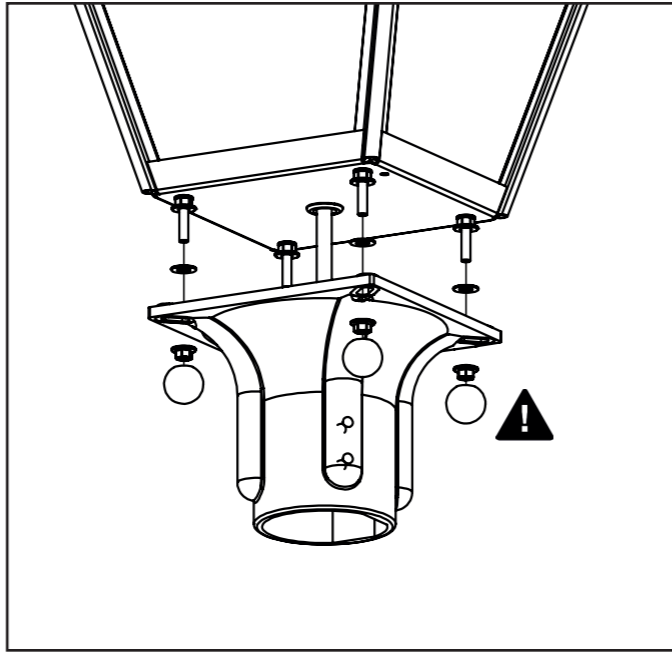

! PLEASE NOTE THAT THE DECORATIVE BALLS ARE DECORATIVE ONLY AND SHOULD NOT BE USED TO SECURE THE LANTERN IN PLACE.

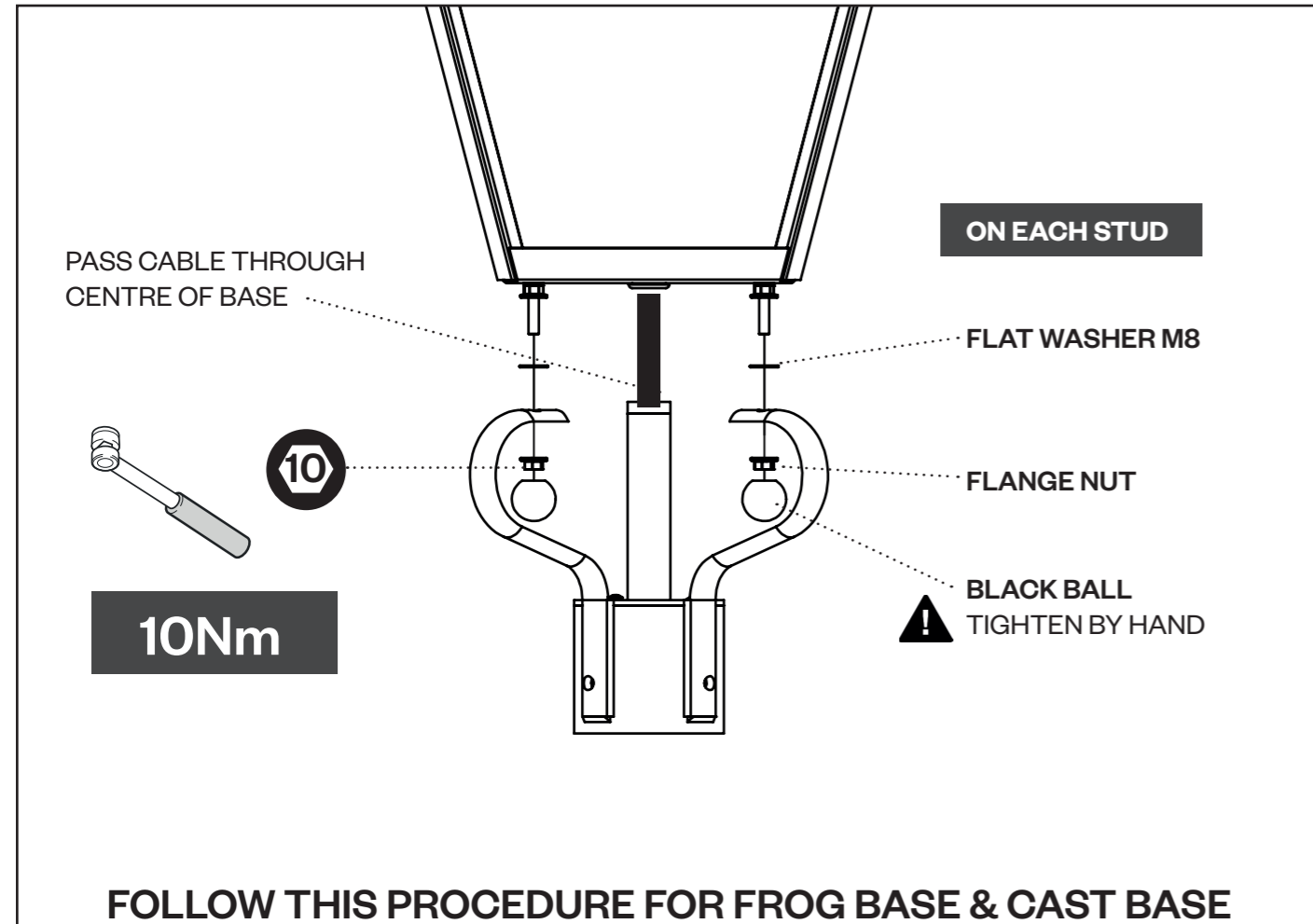

WIRING

! Wiring procedure should be carried out before mounting the luminaire on the column

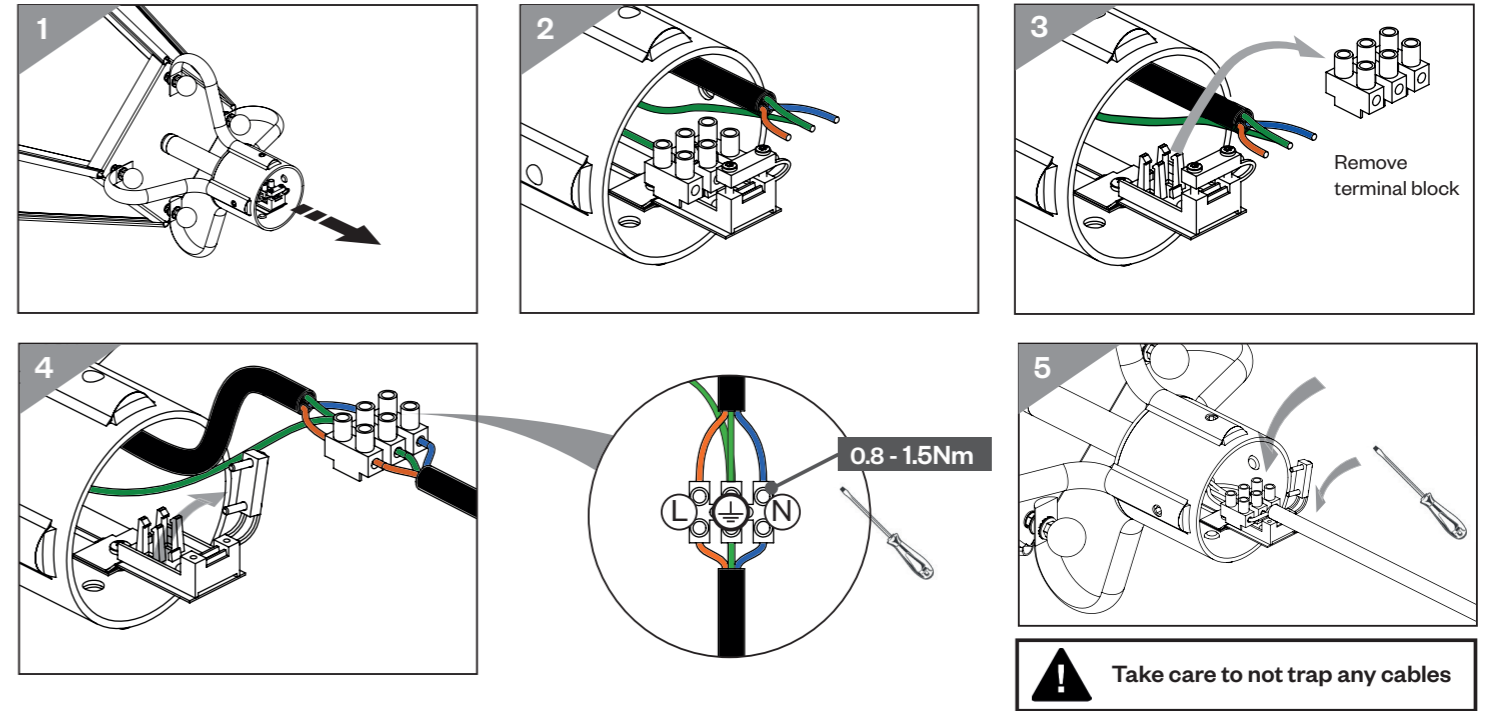

5 CORE CABLE (DALI)

